



**20 Waterton Cottages, Waterton Lane, Mossley, OL5 0NF**  
**Offers In The Region Of £200,000**

STONE TERRACE | IDEAL FIRST PURCHASE | TWO BEDROOMS | WELL PRESENTED | VIEWING ADVISED |  
The property on Waterton Lane comprises of a lounge, kitchen diner, two bedrooms, bathroom & WC and landing. There is an attractive patio area to rear. In a quiet, traffic free position within walking distance of Top Mossley where a variety of local shops and amenities can be found.

## ACCOMMODATION

### GROUND FLOOR

#### LOUNGE

14'0" x 14'1" (4.28 x 4.31)



#### KITCHEN DINER

14'0" x 7'1" (4.28 x 2.17)



Sink unit. Electric hob, oven and extractor. A range of wall and base units with worktops.

### FIRST FLOOR

#### BEDROOM ONE

14'0" x 10'7" (4.28 x 3.23)



#### BEDROOM TWO

7'11" 10'8" (2.43 3.26)



## BATHROOM & WC

5'0" x 8'6" (1.53 x 2.60)



Three piece white suite, shower over the bath and shower screen, fully tiled.

### LANDING

### EXTERNALLY



Attractive patio area to rear.

### SERVICES -

All main services are installed.

### IMPORTANT NOTICE -

No checks have been made of any services (water, electricity, gas and drainage) heating appliances or any other electrical or mechanical equipment in this property.

### DISCLAIMER -

Wild & Griffiths themselves and the vendors/lessors of this property give notice that these particulars have been prepared in good faith having regard to the property misdescriptions act (1991). Measurements are intended for descriptive purposes only and are believed to be correct but any intending purchasers should not rely on them as statements or representations of fact. Any intending purchaser must satisfy themselves by inspection or otherwise as to the information provided and condition of the property and no warranty is given by the vendor, their agents or any other person in their employment. The property is offered subject to contract and still being available at the time of enquiry and no responsibility can be accepted for any loss or expenses incurred in viewing.



## Ground Floor

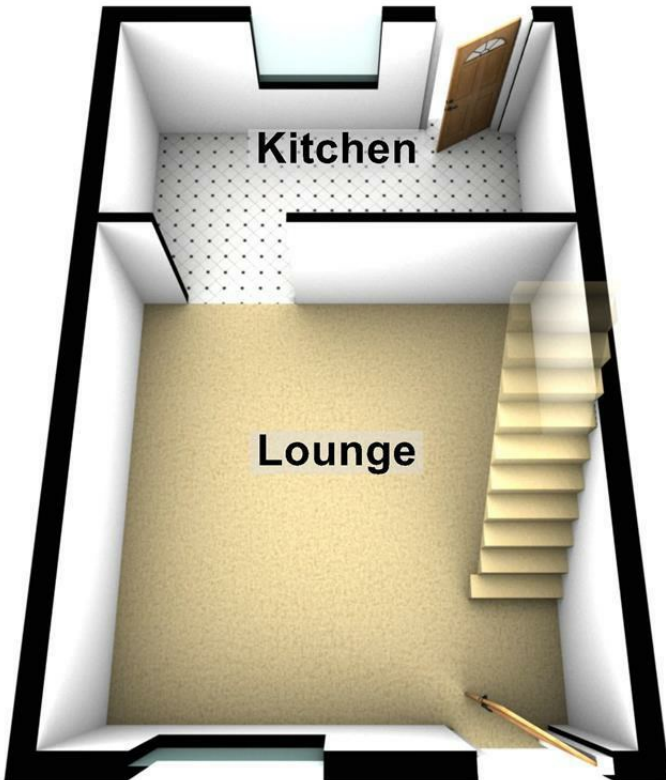

## First Floor

